

TPLSU60 SERIES

60W LED Power Supply

Features:

- Wide Operating Voltage 90 to 264 VAC, 47 to 63 Hz
- Internal EMI filter
- Active Power Factor Correction
- C.C. Mode + C.V. Mode
 - Constant Current: 0.84~5.45A
 - Constant Voltage: 11~58V
- Over Voltage, Over Current, Over Over Temperature (optional)
- Class I
- 3 year warranty



Electrical Characteristics:

Vin	Safety Approvals	Input Voltage Range	100~277VAC
		Operate Voltage Range	90~264VAC
fin		Input Frequency	47~63Hz
PF	Power Factor Correction	Io=Full load, Vin=90~264VAC	0.90~1.0
Po		Output Power Range	See rating chart
Vo		Output Voltage Range	See rating chart
Io		Output Current Range	See rating chart
Iil	Input Current (Low Line)	Io=Full load, Vin=100VAC	1.0A
Iih	Input Current (High Line)	Io=Full load, Vin=240VAC	0.4A
Ir	Low Line Inrush Current	Io=Full load, 25°C, Cool start, Vin=115VAC	35A (max.)
	High Line Inrush Current	Io=Full load, 25°C, Cool start, Vin=230VAC	70A (max.)
Eff	Efficiency	Io=Full Load, Vin=230VAC	84~90%
REG-i	Line Regulation	Io=Full Load	0.5~1%
REG-o	Load Regulation	Vin=230VAC (C.C.)	3%
	Load Regulation	Vin=230VAC (C.V.)	3%
OVP	Over Voltage Protection		103~105%
OCP	Over Current Protection	C.C.	103~105%
	Over Current Protection	C.V.	140~180%
Ttr	Time of Transient Response	Io=Full Load to Half Load, Vin=100VAC	4mS (max.)
Th	Hold-Up Time (C.V.)	Io=Full Load, Vin=110VAC	8mS (min.)
Ts	Start Up Time	Io=Full Load, Vin=100VAC	1S (max.)
Vp-p	Ripple & Noise (Peak to Peak)	Full Load, Vin=90VAC	1% (max.)
Ilk	Safety Ground Leakage Current	Vin=240VAC/60Hz	0.75mA (max.)
TC	Temperature Coefficient	All output	±0.04%/°C
Pno	No-Load Power Consumption	No load, Vin=230VAC	See rating chart
Vps	Dielectric Withstanding Voltage	Primary to secondary	4242VDC (min.)
Vpg	Dielectric Withstanding Voltage for Primary to PE	Primary to PE	2121VDC (min.)
Ris	Isolation Resistance	Test Voltage=500VDC	50MΩ (min.)

Environmental

To	Operating Temperature	See derating curve
Ts	Storage Temperature	-40~85°C
Ho	Operating Humidity	0~95%
Hr	Storage Humidity	0~95%
MTBF	Operating Temperature at 25°C, Calculated per MIL-HDBK-217F	0.1M Hrs (min.)
Pd	Derate linearly from 100% load at 50°C to 50% load at 70°C	

Application:

- Outdoor installations

Safety Approvals:

cULus CE CB

IP67 RoHS 2002/95/EC COMPLIANT

UL/c-UL (UL8750:1st edition)

TUV (EN/IEC61347-1:2008, EN/IEC61347-2-13:2006)

CE-EMC (EN55015:2006 & EN61547:1995+A1:2000)



TPLSU60 SERIES

60W LED Power Supply

Output Voltage And Current Rating Chart (Single Output) :

Model Number	Output Voltage	Output Current	Total Regulation (C.V.)	Max. Output Power	Pno (max.)
TPLSU60-105-11V	11 VDC	0 ~ 5.45 A	3%	60W	1W
TPLSU60-105-12V	12 VDC	0 ~ 5.00 A	3%	60W	1W
TPLSU60-105-13V	13 VDC	0 ~ 4.61 A	3%	60W	1W
TPLSU60-106-13V	13 VDC	0 ~ 4.61 A	3%	60W	1W
TPLSU60-106-14V	14 VDC	0 ~ 4.28 A	3%	60W	1W
TPLSU60-106-15V	15 VDC	0 ~ 4.00 A	3%	60W	1W
TPLSU60-106-16V	16 VDC	0 ~ 3.75 A	3%	60W	1W
TPLSU60-107-16V	16 VDC	0 ~ 3.75 A	3%	60W	1W
TPLSU60-107-17V	17 VDC	0 ~ 3.52 A	3%	60W	1W
TPLSU60-107-18V	18 VDC	0 ~ 3.33 A	3%	60W	1W
TPLSU60-107-19V	19 VDC	0 ~ 3.15 A	3%	60W	1W
TPLSU60-107-20V	20 VDC	0 ~ 3.00 A	3%	60W	1W
TPLSU60-107-21V	21 VDC	0 ~ 2.85 A	3%	60W	1W
TPLSU60-108-21V	21 VDC	0 ~ 2.85 A	3%	60W	1W
TPLSU60-108-22V	22 VDC	0 ~ 2.72 A	3%	60W	1W
TPLSU60-108-23V	23 VDC	0 ~ 2.60 A	3%	60W	1W
TPLSU60-108-24V	24 VDC	0 ~ 2.50 A	3%	60W	1W
TPLSU60-108-25V	25 VDC	0 ~ 3.40 A	3%	60W	1W
TPLSU60-108-26V	26 VDC	0 ~ 2.30 A	3%	60W	1W
TPLSU60-108-27V	27 VDC	0 ~ 2.22 A	3%	60W	1W
TPLSU60-109-27V	27 VDC	0 ~ 2.22 A	3%	60W	1W
TPLSU60-109-28V	28 VDC	0 ~ 2.14 A	3%	60W	1W
TPLSU60-109-29V	29 VDC	0 ~ 2.06 A	3%	60W	1W
TPLSU60-109-30V	30 VDC	0 ~ 2.00 A	3%	60W	1W
TPLSU60-109-31V	31 VDC	0 ~ 1.93 A	3%	60W	1W
TPLSU60-109-32V	32 VDC	0 ~ 1.87 A	3%	60W	1W
TPLSU60-109-33V	33 VDC	0 ~ 1.81 A	3%	60W	1W

Model Number	Output Voltage	Output Current	Total Regulation (C.V.)	Max. Output Power	Pno (max.)
TPLSU60-110-33V	33 VDC	0 ~ 1.81 A	3%	60W	1W
TPLSU60-110-34V	34 VDC	0 ~ 1.76 A	3%	60W	1W
TPLSU60-110-35V	35 VDC	0 ~ 1.71 A	3%	60W	1W
TPLSU60-110-36V	36 VDC	0 ~ 1.66 A	3%	60W	1W
TPLSU60-110-37V	37 VDC	0 ~ 1.62 A	3%	60W	1W
TPLSU60-110-38V	38 VDC	0 ~ 1.57 A	3%	60W	1W
TPLSU60-110-39V	39 VDC	0 ~ 1.53 A	3%	60W	1W
TPLSU60-110-40V	40 VDC	0 ~ 1.50 A	3%	60W	1W
TPLSU60-111-40V	40 VDC	0 ~ 1.50 A	3%	60W	1W
TPLSU60-111-41V	41 VDC	0 ~ 1.46 A	3%	60W	1W
TPLSU60-111-42V	42 VDC	0 ~ 1.42 A	3%	60W	1W
TPLSU60-111-43V	43 VDC	0 ~ 1.39 A	3%	60W	1W
TPLSU60-111-44V	44 VDC	0 ~ 1.36 A	3%	60W	1W
TPLSU60-111-45V	45 VDC	0 ~ 1.33 A	3%	60W	1W
TPLSU60-111-46V	46 VDC	0 ~ 1.30 A	3%	60W	1W
TPLSU60-111-47V	47 VDC	0 ~ 1.27 A	3%	60W	1W
TPLSU60-111-48V	48 VDC	0 ~ 1.25 A	3%	60W	1W
TPLSU60-111-49V	49 VDC	0 ~ 1.22 A	3%	60W	1W
TPLSU60-111-50V	50 VDC	0 ~ 1.20 A	3%	60W	1W
TPLSU60-112-50V	50 VDC	0 ~ 1.20 A	3%	60W	1W
TPLSU60-112-51V	51 VDC	0 ~ 1.17 A	3%	60W	1W
TPLSU60-112-52V	52 VDC	0 ~ 1.15 A	3%	60W	1W
TPLSU60-112-53V	53 VDC	0 ~ 1.13 A	3%	60W	1W
TPLSU60-112-54V	54 VDC	0 ~ 1.11 A	3%	60W	1W
TPLSU60-112-55V	55 VDC	0 ~ 1.09 A	3%	60W	1W
TPLSU60-112-56V	56 VDC	0 ~ 1.07 A	3%	60W	1W
TPLSU60-112-57V	57 VDC	0 ~ 1.05 A	3%	60W	1W
TPLSU60-112-58V	58 VDC	0 ~ 1.03 A	3%	60W	1W

The output voltage range will from V_0 to $0.6 \cdot V_0$ of each model on C.C. Mode.

Input Connector : SJTW, 18AWGx3C (1Ft)

Output Connector : SJTW, 18AWGx2C (1Ft)

Mechanical Specifications:

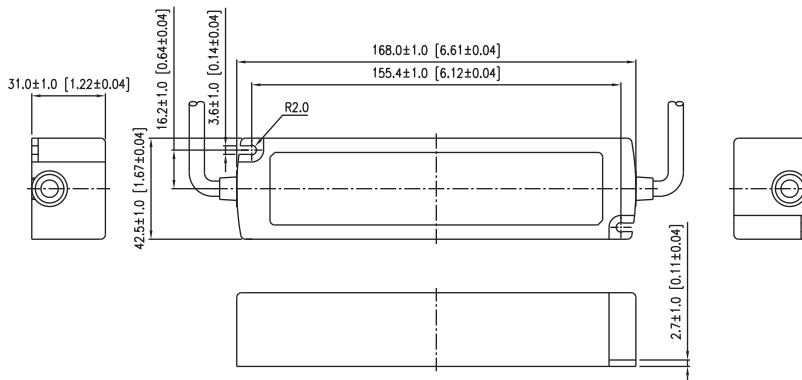

Derating Curve :

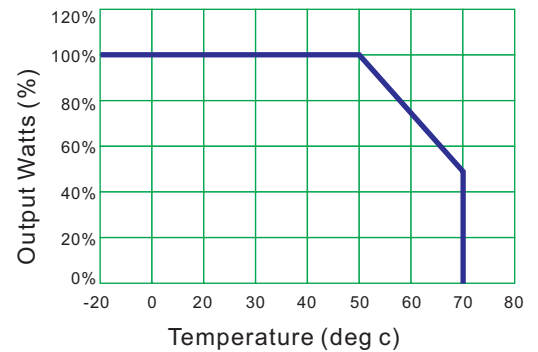

1. Operating Temperature: -20 to 70°C
2. Derate linearly from 100% load at 50°C to 50% load at 70°C

Note:

1. Dimensions are shown in inches or mm .
2. Weight: 530~600gs approx.

